

RoHS

REV	ECN NO.	DESCRIPTION	DESIGN	APPROVAL	DATE
A1	NEW	更换图框			2023.11.25

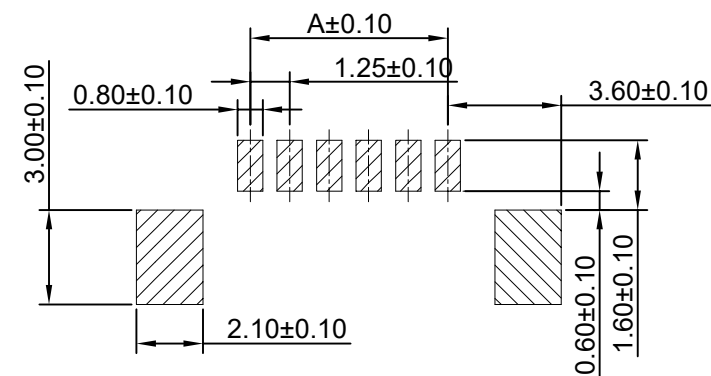
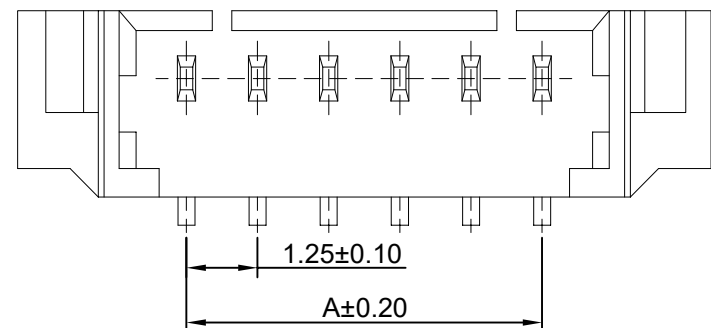
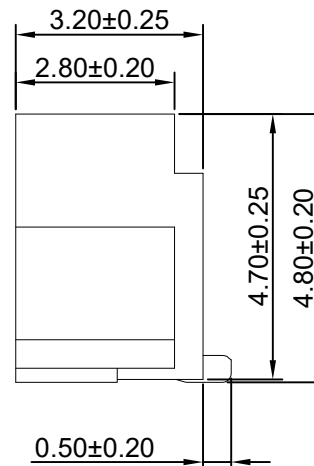
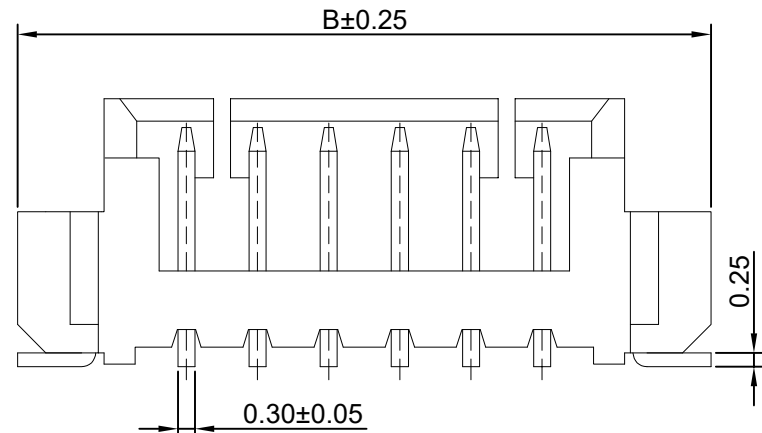

PCB LAYOUT

SPECIFICATIONS

- Current rating: 1A AC, DC
- Temperature range: $-40^{\circ}\text{C} \sim +105^{\circ}\text{C}$
- Insulation resistance: $100\text{M}\Omega$ Min.
- Withstanding voltage: 250V AC/ minute.
- Contact resistance: 20m Ω Max.

Material:

Insulator: PA9T UL 94V-0
 Contact: Phosphor Bronze or Brass
 Plating: Plated Tin
 Circuits: 02~20P
 Mate with: XFCN P1250 series Housing
 Ordering Code:

M1250VS-XX
 1 2

1. 序列号
2. Pin位数 02-20P

No. of PIN/ROW	Dimension	
	A	B
2	1.25	7.35
3	2.50	8.60
4	3.75	9.85
5	5.00	11.10
6	6.25	12.35
7	7.50	13.60
8	8.75	14.85
9	10.00	16.10
10	11.25	17.35
11	12.50	18.60
12	13.75	19.85
13	15.00	21.10
14	16.25	22.35
15	17.50	23.60
16	18.75	24.85
18	21.25	27.35
20	23.75	29.85

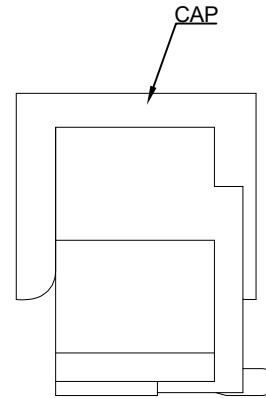

X.±0.50	X.°±
.XX±0.25	.X°±
.XXX±0.15	.XX°±
.XXX±0.10	.XXX°±
UNITS:	mm

PART NO: M1250VS-XX

TITLE: 1.25mm Crimp Style Connectors

APPD: Chen ZhiQiang

CHKD: Liu Wei

DRAW: Chen HongJiang

DATE: 2024.05.24

XFCN 兴飞连接器

0769-82001899
 www.xfconn.com

DWG NO:

VIEW:

SCALE: SHEET: REV

1/1 A1

THESE DRAWINGS AND SPECIFICATIONS ARE THE PROPERTY OF XFCN AND SHALL NOT BE REPRODUCED, COPIED OR CUED IN ANY MANNER WITHOUT THE PRIOR WRITTEN CONSENT OF XFCN